

LOT #10, #11, & #12  
BLOCK #11  
EXISTING MULTI  
FAMILY PROJECT

LOT #13  
BLOCK #11  
EXISTING MULTI  
FAMILY PROJECT

LOT #14  
BLOCK #11  
EXISTING MULTI  
FAMILY PROJECT

LOT #2  
BLOCK #11  
EXISTING SINGLE  
FAMILY PROJECT

LOT #9  
BLOCK #11  
EXISTING MULTI  
FAMILY PROJECT

LOT #3  
BLOCK #11  
EXISTING SINGLE  
FAMILY PROJECT

LOT #4  
BLOCK #11  
EXISTING MULTI  
FAMILY PROJECT

THIS SHEET IS FOR PHOTOMETRIC  
INFORMATION ONLY. ALL OTHER  
ELECTRICAL DESIGN IS UNDER A  
SEPARATE PERMIT.

SEE FIXTURE SPEC SHEETS  
ON SHEET PH0.1.

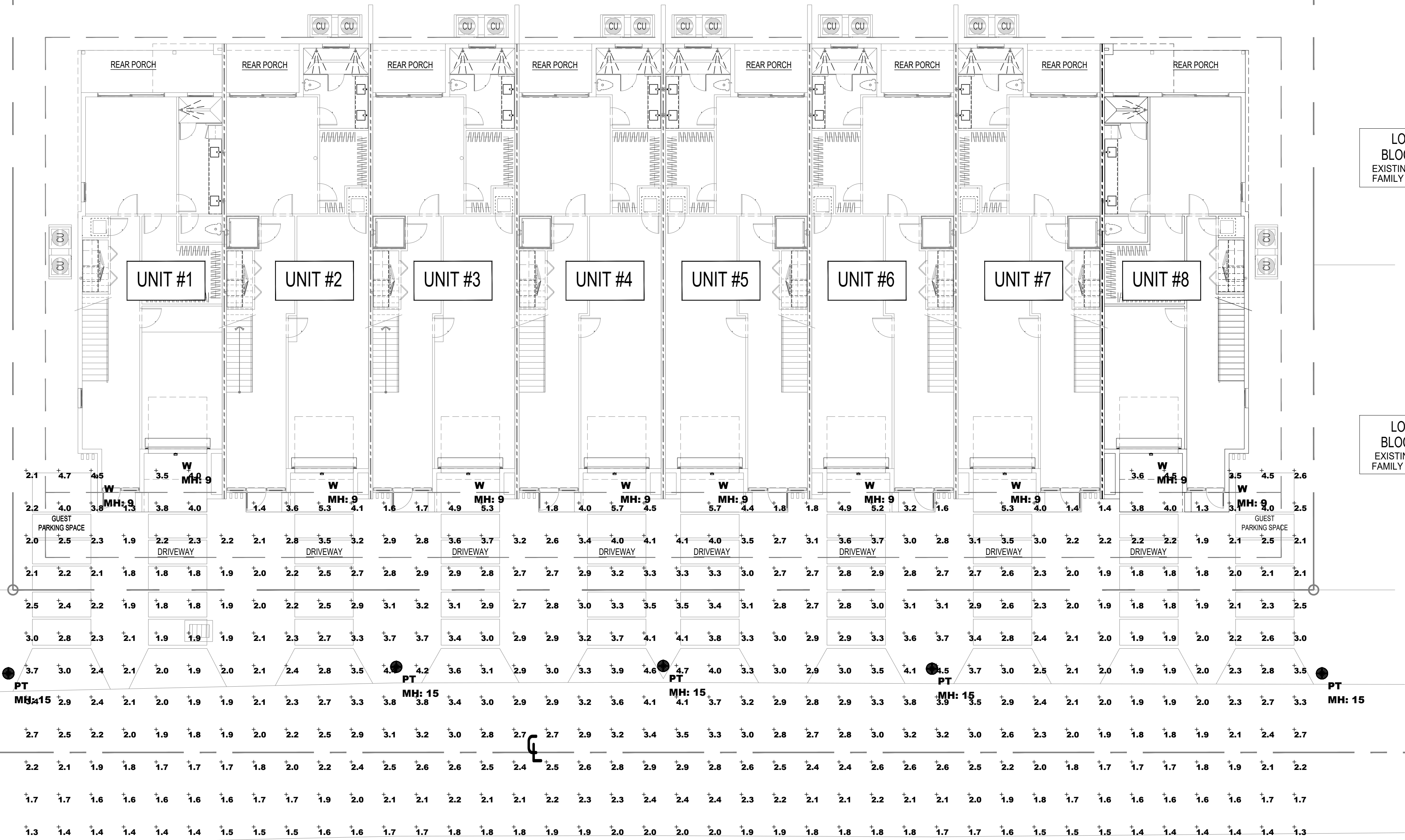

Luminaire Schedule: 3305 SE 5TH STREET TOWNHOMES - SITE POMPANO BEACH, FL									
Symbol	Qty	Label	Arrangement	Manufacturer	Catalog Number	Mounting	LLF	Lum Lumens	Lum Watts
	5	PT	Single	U.S. Architectural Lighting	PAC18-PT2/PLED-VSQ-W/36LED-700mA/40K/UNV	POST TOP MOUNT A.F.G.	0.903	10859	82.6
	10	W	Single	Lithonia Lighting	WDGE1 LED P0 40K 80CRI VW	WALL MOUNT A.F.F.	0.903	761	6.7947

Calculation Summary: 3305 SE 5TH STREET TOWNHOMES - SITE POMPANO BEACH, FL							
Label	Calc Type	Units	Avg	Max	Min	Avg/Min	Max/Min
DRIVEWAYS	Illuminance	Fc	2.89	5.7	1.3	2.22	4.38
RIGHT-OF-WAY	Illuminance	Fc	2.26	4.1	1.3	1.74	3.15

PHOTOMETRIC SITE PLAN

1" = 10'-0"

This document has been electronically signed and sealed by Sean Geary, P.E. using a digital signature and date. Signature must be verified on any electrical copies. Printed copies of this document are not considered signed and sealed without a wet or raised seal with pen signature.

PRIOR TO SUBMITTING THE BID, THE CONTRACTOR SHALL FIELD VERIFY ALL EXISTING CONDITIONS AND INFORM THE ARCHITECT AND THE ENGINEER OF ANY DISCREPANCY BETWEEN THESE DOCUMENTS AND THE EXISTING CONDITIONS AND SHALL INCLUDE IN THE BID TO CORRECT THE SAME AS DIRECTED. THE ENGINEER AND THE ARCHITECT, ARE NOT RESPONSIBLE FOR ANY ADDITIONAL COSTS RESULTING FROM VERIFIABLE EXISTING CONDITIONS DISCOVERED AFTER CONTRACT HAS BEEN AWARDED. NO CHANGES SHALL BE MADE TO THESE PLANS WITHOUT PRIOR APPROVAL FROM THE ENGINEER OF RECORD. ALL CHANGES SHALL BE SUBMITTED FOR REVIEW PRIOR TO INSTALLATION. NOT FOR BID UNTIL PERMIT SET HAS BEEN ISSUED.

CA. LIC. NO. 31328 | SEAN GEARY, P.E. LIC. NO. FL87362

2781 VISTA PARKWAY, SUITE 11  
WEST PALM BEACH, FLORIDA 33411

PHONE: 561.419.8977  
EMAIL: INFO@APD-ENGINEERING.COM